

HEATSCOPE®

ORIGINAL MONTAGE- UND GEBRAUCHSANLEITUNG

Elektrischer Ambiente Carbon Heizstrahler
für Innen- und Außenbereiche

DE

ORIGINAL INSTALLATION AND INSTRUCTION MANUAL

Electric ambient carbon radiant heater
for indoor and outdoor areas

EN

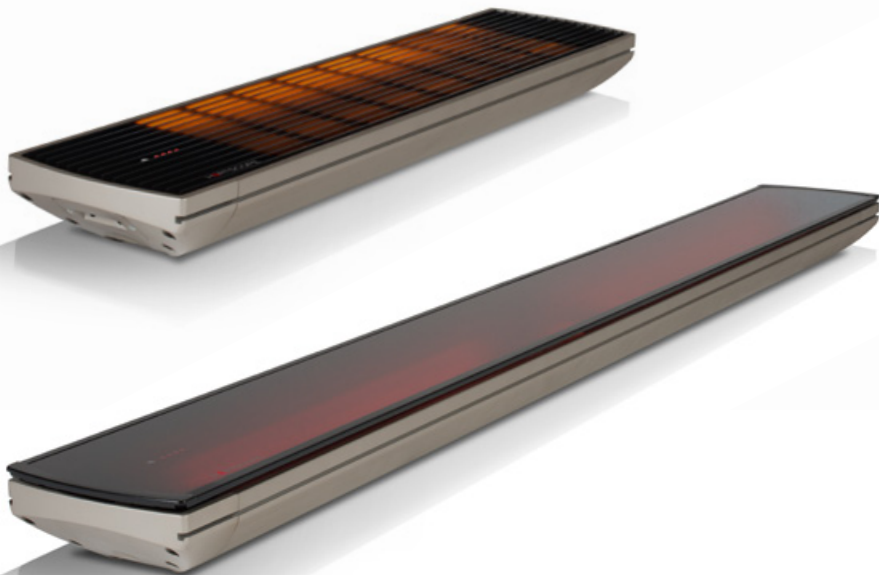

Wandmontage / Wall mounting

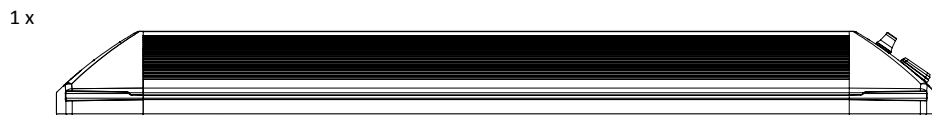
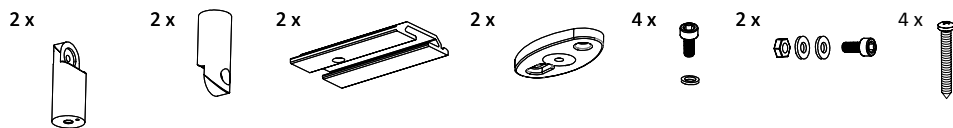

1. 2 x

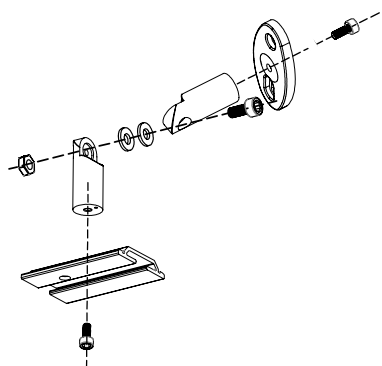

2.

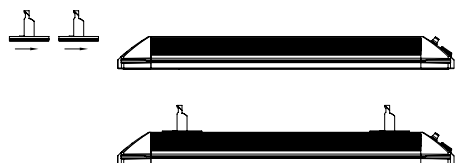

3.



4. 2 x

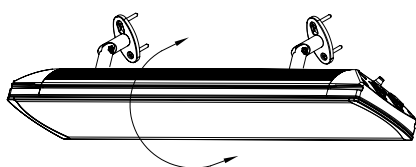

Dear Customer,

Thank you for choosing a HEATSCOPE® electric radiant heater. This top-quality infrared ambient radiant heater is manufactured in Germany and complies with the relevant CE/EN/DIN standards and EU directives. Only tested, environmentally friendly materials and components are used.

Designed for private and commercial use, fast medium wave HEATSCOPE® carbon radiant heaters produce heat within seconds wherever it is needed – on patios, in conservatories and glasshouses, in pavilions and smoking areas, in spa and outdoor areas. The infrared radiant heater allows you to transport heat over a distance of up to 3.5 metres, ideally in a specific direction. When installed correctly, the radiant heater uses 30–40% less energy than conventional halogen radiant heaters to produce the same heat. This is possible thanks to the special carbon technology in conjunction with a patented, highly efficient reflector and ventilation system.

Before installing the unit, please read this instruction manual carefully. Follow the information given to avoid endangering yourself, your family, your friends and your acquaintances. If you have any questions, contact the vendor or manufacturer.

Please keep this instruction manual in a safe place so that you can refer to it later on if necessary. Pass on the manual to any subsequent owner of the HEATSCOPE® unit and ensure that any supplements received are included along with it.

If you lose the manual, ask the vendor or manufacturer for a new copy.

Prior to installation, ensure that the operating voltage matches the one specified on the name plate of the HEATSCOPE® unit.

This instruction manual is intended solely for the standard products available. The technical data, installation requirements and dimensions of special versions may differ.

1. Dimensions and specifications

Art.-No.	Colour	Power	Weight	Sizes (incl. brackets)
MHS-SM1600BK.100 / MHS-SP1600BK.100	Front: black Corpus: titan	1600 W	3.5 kg	600 x 184 x 82 mm
MHS-SM2200BK.100 / MHS-SP2200BK.100		2200 W	4.0 kg	670 x 184 x 82 mm
MHS-SM2800BK.100 / MHS-SP2800BK.100		2800 W	4.5 kg	810 x 184 x 82 mm
MHS-SM1600WT.100 / MHS-SP1600WT.100	Front: white Corpus: white	1600 W	3.5 kg	600 x 184 x 82 mm
MHS-SM2200WT.100 / MHS-SP2200WT.100		2200 W	4.0 kg	670 x 184 x 82 mm
MHS-SM2800WT.100 / MHS-SP2800WT.100		2800 W	4.5 kg	810 x 184 x 82 mm
VT Series				
MHS-VT1600BK.100 / MHS-VE1600BK.100	Front: black Corpus: titan	1600 W	6.0 kg	810 x 184 x 90 mm
MHS-VT2200BK.100 / MHS-VE2200BK.100		2200 W	8.0 kg	1160 x 184 x 90 mm
MHS-VT3200BK.100 / MHS-VE3200BK.100		3200 W	11.0 kg	1660 x 184 x 90 mm
MHS-VT1600WT.100 / MHS-VE1600WT.100	Front: white Corpus: white	1600 W	6.0 kg	810 x 184 x 90 mm
MHS-VT2200WT.100 / MHS-VE2200WT.100		2200 W	8.0 kg	1160 x 184 x 90 mm
MHS-VT3200WT.100 / MHS-VE3200WT.100		3200 W	11.0 kg	1660 x 184 x 90 mm

1. Use and models

HEATSCOPE® SPOT

black or white coated protective fin · titanium coloured or white coated aluminium body · energy-efficient double carbon heating elements with satin-finish surface · patented reflector heating system with back-ventilated rear side · includes accessories for wall or ceiling installation · visible light: < 600 lux · radiant efficiency: > 94% · max. power in < 3 sec.

HEATSCOPE® SPOT – manual control, 4-pole cable

SPECIFICATIONS: ON/OFF + two manually switchable power levels (100% or 50%)



MHS-SM1600BK.100, MHS-SM2200BK.100, MHS-SM2800BK.100
MHS-SM1600WT.100, MHS-SM2200WT.100, MHS-SM2800WT.100

HEATSCOPE® SPOT – 3 power levels, remote controllable, 3-pole cable

SPECIFICATIONS: ON/OFF + three remote controllable power levels (100%, 80% or 50%), IR remote control



MHS-SP1600BK.100, MHS-SP2200BK.100, MHS-SP2800BK.100
MHS-SP1600WT.100, MHS-SP2200WT.100, MHS-SP2800WT.100

HEATSCOPE® VISION

black or white glass ceramic front screen · titanium coloured or white coated aluminium body · energy-efficient double carbon heating elements with satin-finish surface · patented reflector heating system with back-ventilated rear side · includes accessories for wall or ceiling installation · visible light: < 300 lux · radiant efficiency: ≥ 90% · max. power in < 5 sec.

HEATSCOPE® VISION – manual control, 4-pole cable

SPECIFICATIONS: ON/OFF + two manually switchable power levels (100% or 50%, external)



MHS-VE1600BK.100, MHS-VE2200BK.100, MHS-VE3200BK.100
MHS-VE1600WT.100, MHS-VE2200WT.100, MHS-VE3200WT.100

HEATSCOPE® VISION – remote controllable, 3-pole cable

SPECIFICATIONS: ON/OFF + three remote controllable power levels (100%, 80% or 50%), IR remote control



MHS-VT1600BK.100, MHS-VT2200BK.100, MHS-VT3200BK.100
MHS-VT1600WT.100, MHS-VT2200WT.100, MHS-VT3200WT.100

3. Safety information

The relevant local building and fire safety regulations must be observed.

WARNING: The heater must not be used in small rooms inhabited by people who cannot leave the room unaided, unless constant supervision is ensured.

1.

Please check that your HEATSCOPE® radiant heater and accessories are complete and not damaged. If the housing or reflector is deformed/damaged or the heating element is broken, do not use the HEATSCOPE® unit. Please contact the vendor or the manufacturer.

The cable must not be crushed or damaged.

If the unit or accessories show signs of defects, cracking, breakage or other damage, discontinue use and have them repaired. In this case, disconnect the unit from the power supply, return it to the manufacturer or dispose of it. The unit should be labelled accordingly to prevent it being reconnected.

2.

The HEATSCOPE® features an omnipolar „ON/OFF“ switch. The unit can be controlled manually either using an IR remote control (supplied, depending on the model) or a selector switch on the unit itself. The unit must be connected to a residual current circuit breaker and a fuse.

A professional specialist company can also install the HEATSCOPE® radiant heater flush using the optional recessed mounting tray and a buried connecting cable. In this case, an omnipolar switch must be integrated into the supply cable.

3.

The unit may only be used with an approved isolating system. The heater comes as standard with a separate open-ended cable for connection purposes.

4.

When installing the HEATSCOPE® radiant heater, ensure that the lower edge of the unit is at least 180 cm from the ground and the safety clearances from the wall and ceiling set out in this manual (see below) are maintained. Always maintain a distance of at least 150 cm from textiles and other flammable materials.

5.

The radiant heater must not be installed directly below a power source/socket. The sides of the unit must be at least 10 cm from the nearest power source. Sockets/power sources must be freely accessible at all times and comply with the following specifications: 220–240 V, 16 A with 16 A fuse. No other loads may be connected to this power source.

6.

The HEATSCOPE® has an IP 44 protection class rating (dust and splash-proof). Nevertheless, it is advisable to install the unit where it is protected from rain and dust.

7.

In accordance with VDE 0100, Part 701, the radiant heater may only be installed in Area 3 locations in rooms where there is high humidity (bathroom, spa, pool etc.). The distance to the bathtub or shower must be at least 100 cm and the distance to the pool at least 200 cm. If the HEATSCOPE® is installed in such an environment with high humidity, the switches or other operating components must be positioned in such a way that they cannot be touched by persons who are in direct contact with water. Bathroom heaters must not be ope-

rated with a separate automatic thermostat or timer. When a radiant heater is installed in a bathroom, the CE standard requires that at least one heating element visibly „glows“ as soon as the unit is switched on.

8.

As soon as the unit is connected to a power source and switched on using an „ON/OFF“ switch or other operating component, it takes a maximum of 10 seconds until it reached its operating temperature.

9.

CAUTION: Risk of burns!

The front screen or protective fin front gets very hot when the unit is operating.

Do not cover either part of the front or the entire front of the radiant heater. Do not touch any part of the HEATSCOPE® during operation and up to 60 minutes after switching it off.

10.

For your own safety, never dry textiles or other materials using the HEATSCOPE®. Covering the radiant heater may result in a fire!

11.

Ensure that cables, furniture, flammable materials or other objects do not come into contact with the surface of the radiant heater and never cover the unit. Under no circumstances should the unit be covered with insulating or similar materials.

12.

Disconnect the radiant heater from the power supply before cleaning it, adjusting the angle or removing it from the wall/ceiling. If buried cables are used, switch off the power using an omnipolar switch.

13.

Be careful when operating the unit. This unit is not intended for use by persons (including children) with reduced physical, sensory or mental abilities or lack of experience and/or knowledge, unless they are supervised by a person responsible for their safety or have received instructions as to how to operate/use the unit.

14.

The unit must never be used unattended. Children must be supervised at all times to ensure that they do not play with the unit, switch it on unintentionally or adjust it.

15.

Use only the supplied accessories or original accessories approved by the manufacturer. The power cable or other components of the HEATSCOPE® radiant heater may only be replaced by a professional servicing company enlisted by the manufacturer.

16.

Always remember to switch off the unit after use.

4. Unpacking the unit / packaging

Unpack the unit and the accessories carefully. When opening the packaging, do not use sharp objects that could damage the unit.

This product comes supplied in environmentally friendly packaging. All HEATSCOPE® packaging that comes into circulation either directly or via the trade is certified in accordance with §6 of the German Packaging Directive. As a result, all HEATSCOPE® packaging can be disposed of in an environmentally friendly manner in collection containers for packaging materials. The relevant legal regulations must be observed here. Further information is available from the manufacturer.

Care information!

Important! Clean the unit with a damp cloth before using it for the first time. Do not use cleaning products containing alkaline substances such as sodium hydroxide or soap, surfactants or solvents/alcohol.

5. Installation instructions

The INDIVIDUAL options for installing the HEATSCOPE® radiant heater are shown in the diagrams on the first pages of this manual.

Ensure that the radiant heater is fixed securely to the installation surface. In terms of tensile and shear strength, the fixings must be able to withstand at least 3 times the weight of the radiant heater (including accessories) that is to be installed. When installing the unit, use the correct screws and plugs (supplied) for the surface.

Please bear in mind that you always need two fixing brackets to fix your unit safely. Please refer to the minimum installation dimensions for the unit under „minimum distances“.

6. Operation, installation instructions and minimum distances

Once you have installed the unit, you can use it for the first time.

The HEATSCOPE® features an omnipolar „ON/OFF“ switch. You can control the radiant heater manually using a selector switch on the unit itself or using an IR remote control which comes supplied (depending on the model). The unit must be connected to a residual current circuit breaker and a fuse.

It is recommended that you only install the unit in indoor or outdoor areas that are protected from the rain and dust. The radiant heater must be installed at a height of at least 180 cm and at a distance of at least 40 cm from each adjacent wall. The distance between the radiant heater and the rear surface must be at least 10 cm (this distance can be achieved using the supplied fixing accessories). Other protective measures may need to be taken in accordance with local fire safety regulations, e.g. for installation on combustible surfaces.

The radiant heater must not be installed directly below a power socket. The sides of the HEATSCOPE® must be at least 10 cm from any power sockets.

All cables must be positioned so that they cannot come into contact with the radiant heater at any time.

The dimensions given are minimum values and may deviate from the local building and fire safety regulations. The latter must be complied with at all times.

The fixing surfaces shown must comply at least with fire protection class A2. The HEATSCOPE® complies with IP 44 protection class requirements (dust and splash-proof).

Required minimum distances from combustible fixing surfaces:

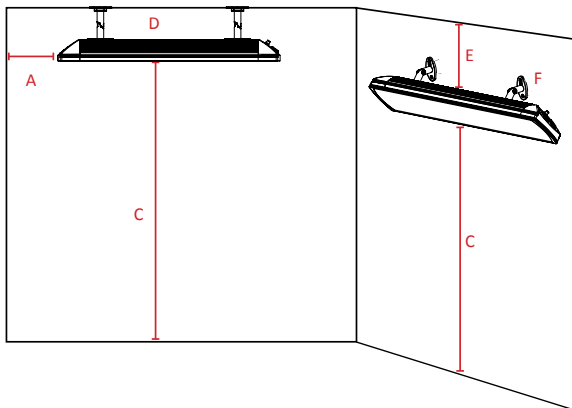
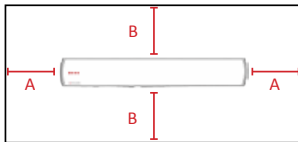

- A min. 40 cm
- B min. 50 cm
- C min. 180 cm
- D min. 17 cm
(can be achieved using the supplied fixing accessories)
- E min. 20 cm (with heating angle <math>< 45^\circ</math>)
- F min. 10 cm
(can be achieved using the supplied fixing accessories)

7. Control

The HEATSCOPE® has four LEDs in the control unit on the left-hand side. The LED on the left is lit whenever the radiant heater is in standby mode. The three smaller LEDs to the right of it indicate the individual power levels. When a heater with manual control is operating, at least two LEDs are always lit. In the case of remote controllable heaters, the left-hand LED indicates standby mode.



Standby LED	Power Level LEDs
----------------	---------------------

7.1. Manual control

The following radiant heaters (serial No. on the housing) are supplied without a remote control and can be controlled on the unit itself or using an external switch (4-pole cable):

MHS-SM1600BK.100, MHS-SM2200BK.100, MHS-SM2800BK.100, MHS-SM1600WT.100, MHS-SM2200WT.100, MHS-SM2800WT.100
MHS-VE1600BK.100, MHS-VE2200BK.100, MHS-VE3200BK.100, MHS-VE1600WT.100, MHS-VE2200WT.100, MHS-VE3200WT.100

These types of heaters can be recognised by the following two switches on the side of the housing:

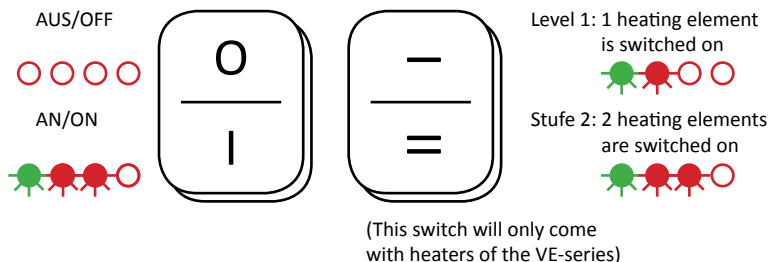

You can switch the unit on („I“) or off („O“) using the AN/AUS (ON/OFF) switch.

Once you have switched the unit on, you can switch between one („-“) and both („=“) heating elements (only heaters of the VE-series).

7.2. Control using IR remote control

The following radiant heaters (serial No. on the housing) are supplied with an IR remote control and, once switched on using the AN/AUS (ON/OFF) button, can be set to one of three levels (50%, 80%, 100%):

MHS-SP1600BK.100, MHS-SP2200BK.100, MHS-SP2800BK.100, MHS-SP1600WT.100, MHS-SP2200WT.100, MHS-SP2800WT.100
MHS-VT1600BK.100, MHS-VT2200BK.100, MHS-VT3200BK.100, MHS-VT1600WT.100, MHS-VT2200WT.100, MHS-VT3200WT.100

These types of heater can be recognised by a single switch on the side of the housing and the blue standby LED:

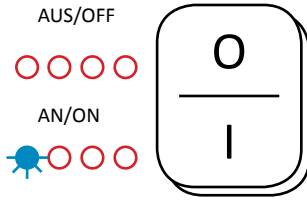

The units come supplied with an infrared remote control which allows you to switch between three power levels (50%, 80% and 100% power):

AN/AUS ON/OFF	
UP + 1 level	
DOWN - 1 level	
MIN. MAX.	



To set your HEATSCOPE® radiant heater to different power levels using the IR remote control, proceed as follows:

- Standby – the radiant heater is ready for use.
- Press the AN/AUS – ON/OFF button.
- The radiant heater is set to level 3 (100% power).
- Press the DOWN or UP button to decrease or increase the power.
- The radiant heater is set to level 2 (80% power).
- Press the DOWN or UP button to decrease or increase the power.
- The radiant heater is now set to level 1 (50% power).
- By pushing the MIN./MAX. button, the radiant heater will jump in the maximum (100%) resp. in the minimum (50%) power level.
- By pushing the AN/AUS – ON/OFF button again, the radiant heater will return to standby mode.

8. Care, maintenance and service

Before cleaning and maintaining your HEATSCOPE®, disconnect it from the power supply or, if buried cables are used, switch it off via the omnipolar switch. Ensure that the unit has cooled down – wait at least 60 minutes after the last use before you start cleaning it.

All surfaces should be cleaned using a damp cloth only. Never use cleaning products containing alkaline substances such as sodium hydroxide or soap, surfactants or solvents such as alcohol.

Use only a very soft cloth or a brush for the reflector and the heating elements.

The power cable or buried cable with omnipolar switch may only be replaced by a professional specialist electrical company enlisted or approved by the manufacturer. Heating elements, other components or parts of the housing may only be replaced by a service organisation enlisted by the manufacturer.

If you yourself or someone enlisted by you carries out repairs, they will not be covered by the guarantee. Improper repairs and incorrect installation or operation shall invalidate the guarantee immediately.

9. Guarantee and warranty

The HEATSCOPE® is guaranteed for 24 months. The warranty period begins on the date on which the new unit was purchased. Expendable parts or defects that affect the usability of the unit only slightly are not covered by the guarantee. When making a guarantee claim, you must provide the original invoice showing the date of purchase and the unit model.

Processing of guarantee claims

Please contact the manufacturer before returning the defective unit along with valid proof of purchase and a detailed description of the fault. The manufacturer will only accept the unit if it is returned with adequate transport packaging which protects it during transport.

The manufacturer will, at its own discretion, fulfil its warranty obligations by either repairing or exchanging the faulty unit or individual parts of the faulty unit. If a unit is replaced, the shape and colour of the new unit may vary slightly from the original one. The original date of purchase shall determine when the guarantee period begins. The guarantee period shall not be extended if the unit was replaced or repaired by the manufacturer.

Warranty exclusions

Damage or defects caused by improper handling or operation as well as defects caused by using non-original parts or the use of accessories not recommended by the manufacturer are not covered by the warranty.

The warranty does not cover damage caused by external influences such as fire, lightning or any transport damages. Liability for consequential damages to persons or property is excluded.

If the serial number of the unit has been changed, removed or defaced, the warranty shall be invalid.

All warranty claims shall be forfeited if the unit is opened, altered, modified, rebuilt or repaired by a person not authorized by the manufacturer.

10. Declaration of conformity

The declaration of conformity is available upon request from the manufacturer.



11. Removal from service / disposal

This product comes supplied in environmentally friendly packaging. All packaging that comes into circulation either directly or via the trade is certified in accordance with §6 of the German Packaging Directive. As a result, all packaging can be disposed of in an environmentally friendly manner in collection containers for packaging materials. The relevant legal regulations must be observed here. Further information is available from the manufacturer.



WEEE-Reg.-Nr.
DE 45650441

When the unit reaches the end of its life, it must be removed from service by a specialist in accordance with the relevant regulations and steps must be taken to ensure that it cannot be put into use again.



The unit must be disposed of professionally and in an environmentally friendly manner. The relevant legal regulations must be observed.

12. Technical data



	HEATSCOPE® SPOT	HEATSCOPE® VISION
Operating voltage	220-240 V	220-240V
Power	1600 W / 2200 W / 2800 W	1600 W / 2200 W / 3200 W
Current	7.83 A / 9.57 A / 12.17 A	6.96 A / 9.57 A / 13.91 A
Cable	1.75 m / 3 x 1.5 mm ² 1.75 m / 4 x 1.0 mm ² 1.75 m / 4 x 1.5 mm ²	1.75 m / 3 x 1.5 mm ² 1.75 m / 4 x 1.0 mm ² 1.75 m / 4 x 1.5 mm ²
Surface temperature	400 °C	280-320 °C
Housing temperature	max. 80 °C	max. 100 °C
Filament temperature	1200-1300 °C	1200-1300 °C
Colour temperature	1550-1650 K	1550-1650 K
Max. Power in	2-3 sec.	4-5 sec.
Visible light	< 600 Lux	< 300 Lux
Min. installation height	min. 1.8 m / max. 4 m	min. 1.8 m / max. 3.5 m
IP protection class	IP 44	IP 44
Manual control	ON/OFF + 100%, 50%	ON/OFF + 100%, 50%
Remote control	ON/OFF + 100%, 80%, 50% IR-Remote Control	ON/OFF + 100%, 80%, 50% IR-Remote Control

13. Electrical connection

To ensure that the HEATSCOPE® is connected correctly, please observe the cross sections of the supplied connecting cable.

The following types of radiant heaters (serial number on the housing) are supplied with an open-ended 3-pole cable with the following cross section:

MHS-SP1600BK.100, MHS-SP2200BK.100, MHS-SP2800BK.100, MHS-SP1600WT.100, MHS-SP2200WT.100, MHS-SP2800WT.100
MHS-VT1600BK.100, MHS-VT2200BK.100, MHS-VT3200BK.100, MHS-VT1600WT.100, MHS-VT2200WT.100, MHS-VT3200WT.100

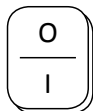

SP- & VT-Models: On the heater the „I“ button has to be switched on!

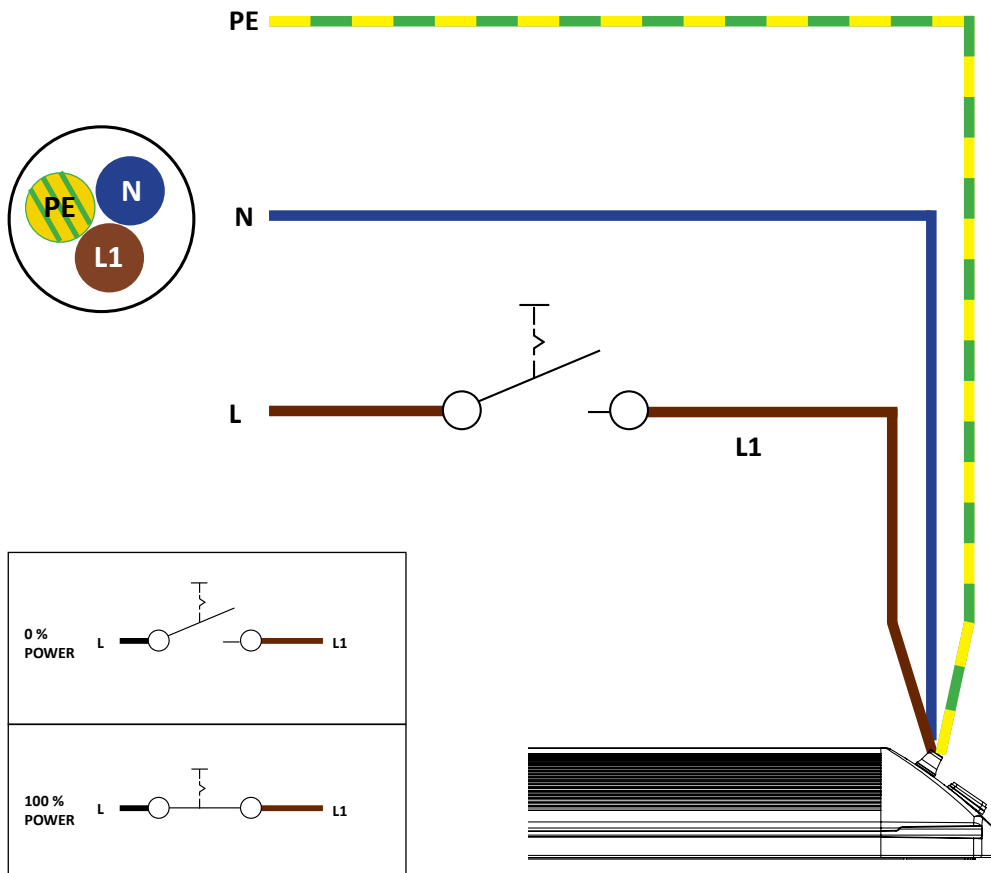

The following types of radiant heaters (serial number on the housing) are supplied with an open-ended 4-pole cable for connecting an external controller and the following cross section:

MHS-SM1600BK.100, MHS-SM2200BK.100, MHS-SM2800BK.100, MHS-SM1600WT.100, MHS-SM2200WT.100, MHS-SM2800WT.100
 MHS-VE1600BK.100, MHS-VE2200BK.100, MHS-VE3200BK.100, MHS-VE1600WT.100, MHS-VE2200WT.100, MHS-VE3200WT.100

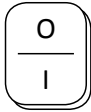

SM-Models: On the heater the „I“ button has to be switched on!

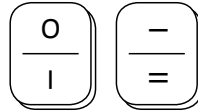

VE-Models: On the heater the „I“ and „=“ button has to be switched on!

