

sirius

series



shademakerTM
architectural shade

owner's manual

WARRANTY:

Upon receipt of your Sirius, please check to ensure you have received all of the parts. Shademaker manufactures all its shade styles from the finest aluminum alloys to ensure the strength, durability and integrity of each and every style. We pride ourselves as a totally vertical operation. This means that we manufacture and produce over 90% of the components used in our products from the raw state. We can monitor every stage of the manufacturing process and maintain a consistent level of quality.

Our only business and focus is shade and shade type products. Our goal is that each and every Shademaker style will exceed your expectations at a competitive price that will make you smile.

Our Limited Warranty is outlined below by individual styles. Please note, wind damage is not covered under any manufacturer's warranty

Our umbrellas are serviceable, meaning that parts can be ordered under warranty at no charge, if found that the damage is a manufacture defect and/or purchased out of warranty to make them whole again.

5 Year Limited Warranty includes the Sirius, Corona and Nova styles. This includes the mast, arms, ribs, center pole, top and bottom hubs and stainless steel hardware only. If there is damage under the warranty, Shademaker will replace and/or repair any item listed in this category at its discretion. The 5 Year Limited Warranty applies to Sunbrella Firesist®, Sunbrella Firesist® PLUS and Sunbrella® Furniture Grade fabrics. Visit www.sunbrella.com/warranty for more details.

10 Year Limited Warranty includes the Sunbrella® Awning & Marine Grade Fabric Collection. Visit www.sunbrella.com/warranty for more details. Labor charges are not covered under this limited warranty.

5 Year Limited Warranty also applies to O'bravia™ Awning Grade fabrics. Visit www.obravia.com for more details. Labor charges are not covered under this limited warranty.

1 Year Limited Warranty covers the powder coat finish on our steel bases. If the powder coat finish flakes, bubbles, peels or loses color; Shademaker will re-finish or replace the defective bases at its discretion. Normal wear and tear is not covered under this limited warranty.

Exclusions: Wind damage, acts of nature (such as, but not limited to, freezing or any type of extreme weather.) Normal wear and tear and failures caused by abusive use are not covered under this warranty.

Those filing warranty claims will be responsible for all shipping, handling and freight charges on all claims to Shademaker in Baldwin Park, CA. All warranty claims must be submitted with the original proof of purchase, date of purchase, name of dealer and the description of the damage. An authorized Shademaker RA# must be listed on all products being returned. The Shademaker warranty is not transferable. Shademaker reserves the right to repair, replace and/or redesign any product that is returned under a warranty claim.

IMPORTANT:

Please read this entire manual before installing or operating your Sirius umbrella.

SIRIUS WIND RESISTANCE GUIDELINES:

Light to Moderate Winds (if used with mount kits)

When installed properly, the Sirius is engineered to handle light to moderate wind conditions in the open canopy position. Please adhere to these wind guidelines:

1. If winds are present, the Sirius should be closed.
2. Do not keep the Sirius in a tilt position if you are experiencing windy conditions.
3. As winds get stronger or, in anticipation or uncertain/severe weather conditions, the canopy should be lowered to the folded position and strapped to the mast.
4. The Sirius should always be left in the folded and strapped position when unattended or not in use.
5. In anticipation of, and during extremely severe weather conditions, it is advisable to remove and store the entire Sirius structure to protect it from storm-related debris.

THE SIRIUS SHADEMAKER SIDEPOST DESIGN

Introduced in 1998, the Sirius is the original Shademaker design. This remarkable technically-refined sidepost rotates 360° and tilts to follow the sun all day. When not in use, the Sirius folds back to the mast in a compact vertical format. The low-maintenance design is ideal for residential pools, patios, decks and gardens.

Two Shapes

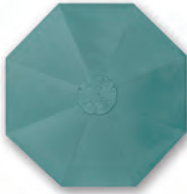

Square



Octagon

Four Sizes

Sirius 2.7	8'9"	Square
Sirius 3.0	9'9"	Square
Sirius 3.0	9'9"	Octagon
Sirius 3.5	11'5"	Octagon

Applications: Primarily residential, or for light commercial settings where an attendant is on site.

Features & Functionality: Rotates 360° around the mast, 3 tilt levels, folds down to mast in a compact vertical format when not in use, unique, fool-proof rotational locking mechanism, state-of-the-art external winding mechanism makes it easy to raise and lower, vented canopy. Canopy fabric is fade, rot and mold resistant; water, oil, and dirt repellent, lightweight, one piece design for seasonal storage and multiple location setup.

Materials & Components: Yacht grade, UV resistant 20 micron anodized aluminum mast, arms, and struts; extremely thick sidewalls; marine grade stainless steel hardware; highest grade polyester winder cordage; glass filled black resin moldings and components; gold passivated and powder coated steel internal stem and base plate.

Wind Resistance: Handles light to moderate winds, position canopy in horizontal positions; lower canopy as winds increase and when unattended. For windy locations, consider the Orion and Galaxy sidepost designs. (Refer to Sirius wind resistance guidelines, on page 2.)

Installation Options

- Bolt to base plate (plate bolted to concrete patio or wooden deck)
- Install in-ground or build into concrete with in-ground fitting
- Free standing base

SHAPES AND SIZES

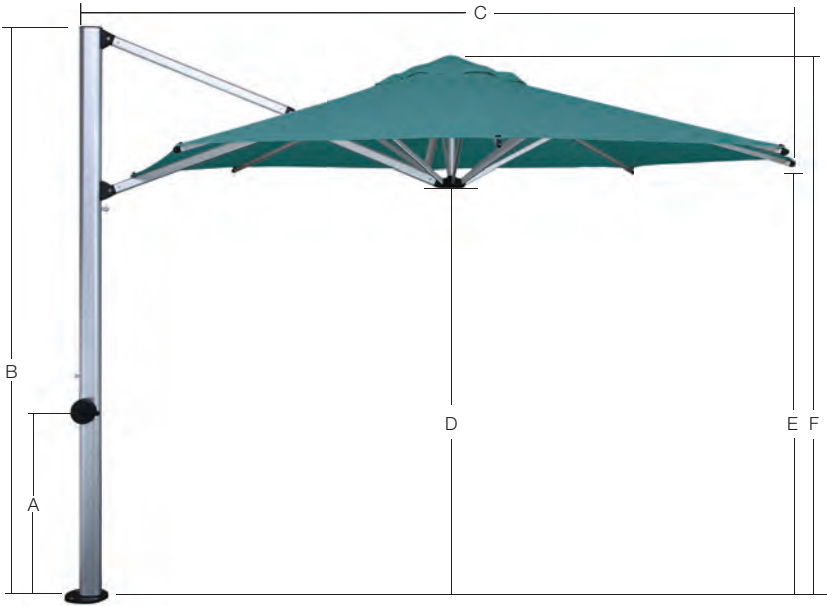

Sirius	2.7m / 8'9"	3.0m / 9'9"	3.0m / 9'9"	3.5m / 11'5"
	Square	Square	Octagon	Octagon

A	2'11"	2'11"	2'11"	2'11"
B	8'9"	9'	8'11"	8'11"
C	9'11"	11'	10'5"	11'9"
D	6'4"	6'3"	6'6"	6'8"
E	6'8"	6'8"	6'11"	7"
F	8'5"	8'5"	8'5"	8'5"
G	1'8"	1'8"	1'8"	1'8"
H	2'	1'7"	3'5"	2'10"

Weight: Approx. 74 lbs.

Mast Shape & Diameter: 2 3/4" x 4 3/8" Oval

Mast Thickness: 1/8"

Arm Thickness: 1/16"

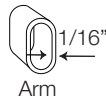
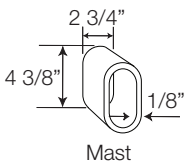

ABOUT THE SIRIUS

This high quality shade solution combines functionality and design in an elegant way and will provide you with years of enjoyment and satisfaction.

- 1. MARINE GRADE ANODIZED ALUMINUM:** Proprietary extrusions of high tensile alloy ensure long life in exposed conditions.
- 2. GLASS FILLED COMPONENTS:** Proprietary moldings are of the latest development for strength and resistance to UV degradation.
- 3. 100% SOLUTION DYED CANVAS:** Top quality canvas leads the world in color-fastness and quality retention properties. Canopies are fade, rot and mold resistant.
- 4. MARINE GRADE STAINLESS STEEL:** The Sirius is equipped with the latest in marine grade stainless steel hardware.

ASSEMBLY

The Sirius will need the Spacer Buttons inserted.

DIAGRAM & LEGEND

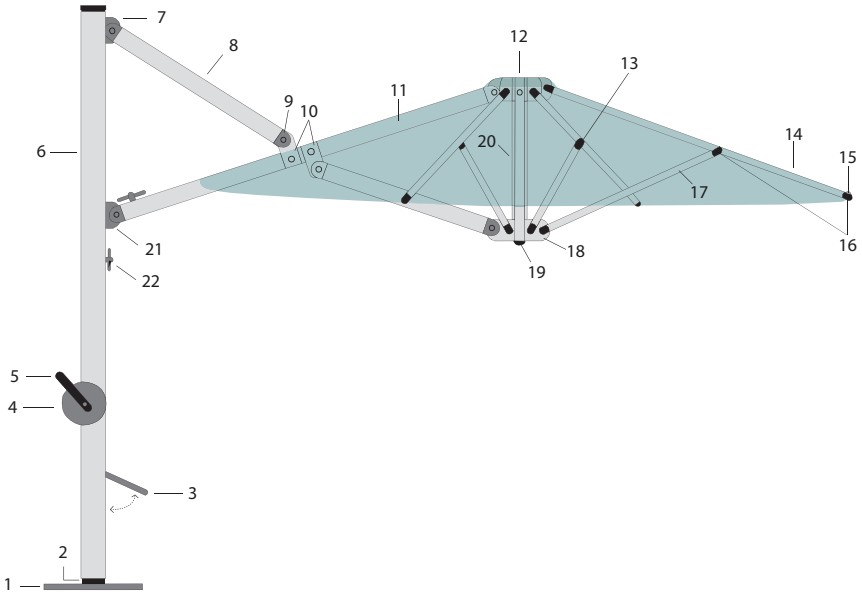

- | | | |
|----------------------|---------------------------|-------------------------|
| 1. Internal Stem | 9. Large Arm End Fitting | 17. Strut |
| 2. Acetal Ring | 10. Large Strop | 18. Lower Hub |
| 3. Turning Handle | 11. Main Arm | 19. Light Adapter |
| 4. Crank | 12. Upper Hub | 20. Center Tube |
| 5. Crank Handle | 13. Small Arm Strop | 21. Slider Car |
| 6. Mast | 14. Main Canopy Arm | 22. Slider Car Stop Pin |
| 7. Upper End Fitting | 15. Canopy Button | |
| 8. Main Support Arm | 16. Small Arm End Fitting | |

COMPONENTS, FITTING & HARDWARE

- 1. INTERNAL STEM:** The Sirius mast slides directly over the internal stem as a sleeve. The plate of the internal stem is 9" in diameter and 3/8" thick. The internal stem is 19" in height and has 10 holes on the top which allow the Sirius to be rotated 360° around the mast.
- 2. BASE PLATE:** The 9" diameter, 1/2" base plate is bolted to an existing concrete slab or to a wooden deck. The internal stem then bolts to the top of the base plate.
- 3. STEM BOLTS:** Four (4) countersunk stem bolts are used to bolt the internal stem to the base plate or to the top of the In-ground fitting. Stem bolts are 3/4" in length.
- 4. MAST OVER INTERNAL STEM:** This photo shows how the mast looks when it is installed onto the internal stem. The internal stem is bolted either to a base plate or the plate of the In-ground fitting.
- 5. TURNING HANDLE:** Rotates umbrella and locks into place.
- 6. CRANK:** The crank facilitates the opening and closing of the Sirius canopy structure.
- 7. SPACER BUTTONS:** Eight (8) spacer buttons need to be inserted into predrilled holes on the eight arms. Spacer buttons must be left inserted at all times as they ensure the Sirius canopy structure opens easily by not allowing the arms to get locked down.

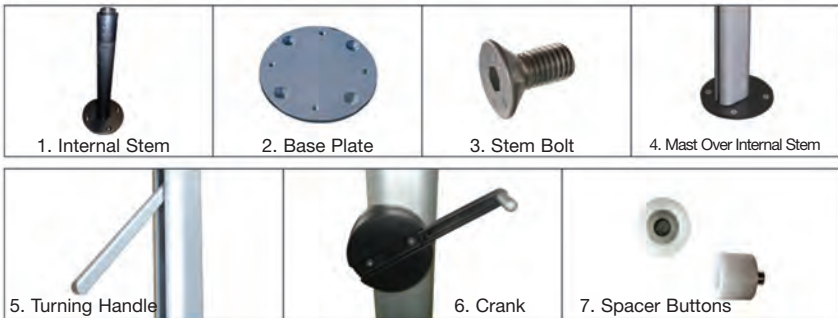

INSTALLATION OPTIONS & GUIDELINES

To ensure longevity, correct installation is essential. There are three standard installation options which provide the best stability for the Sirius. Depending on your situation, you will have requested one or more of the Sirius Mounting Kits at the time of your order. Either the Concrete Mount Kit, the In-Ground Fitting Mount Kit, or the Wooden Deck Mount Kit.

FREE STANDING BASE OPTION: If it is not feasible to mount your Sirius to a concrete patio, wooden deck or in ground, you may have purchased, or need to purchase, an optional free standing base. The free standing base may ONLY be used with the proper weight base (verify with your dealer). This base is an acceptable alternative, but will not offer the same level of stability as the three standard options. If using a free standing base, the wind guidelines change from light to moderate wind to light winds only.

IMPORTANT:

Insert the Spacer Buttons Immediately!

It is imperative that the eight (8) spacer buttons (white plastic cups/screws) are inserted after the canopy is opened for the first time. Spacer buttons stop the arms from closing completely and make it much easier to open the canopy single-handedly.

When opening the canopy for the first time, the arms will have to be helped open manually to facilitate cranking. **Never force the arms!** Once the canopy is open, insert the spacer buttons. Holes have been predrilled and you will need to insert the spacer buttons (white plastic cups/screws), one per arm.

ASSEMBLY INSTRUCTIONS

Two-person team is recommended for assembly.

By now, you have installed your base plate(s) or in-ground fitting, bolted your Internal stem to the base plate or in-ground fitting, and have followed the early instructions to slide the mast over the newly mounted internal stem. The mast should be seated on the Acetal ring. **NOTE:** If not able to have 2 person assembly, remove stem from mast using hexagon wrench. Remove 3 small screws and pull stem from mast. Bolt stem to base plate/base, slide mast over and replace screws.

See below. See diagram to the right.

If the mast is properly seated and bolted to internal stem, the Sirius will not lift. You are now ready to operate your Sirius.

Your Sirius has three positions:

- (1) Tilt position 1
- (2) Tilt position 2
- (3) Horizontal position

NOTE: Tilt position 2 is lower on a square than Tilt position 2 on an octagon as shown below.

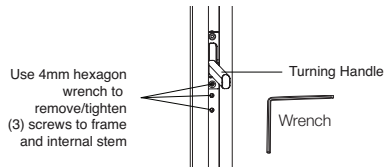

Positions

- 0 Closed position
- 1 Tilt position 1 – blocks extremely angular sun
- 2 Tilt position 2 – blocks moderately angular sun
- 3 Horizontal position

NOTE – DO NOT USE the tilt positions in windy conditions.

TO OPEN THE SIRIUS CANOPY

The following instructions will walk you through the sequential progression of opening the Sirius canopy structure as shown in the picture on the previous page. At any time, you may skip a position and open to the desired position.

OPEN TO THE FIRST POSITION

1. Remove the strap that holds the Sirius to the mast when in the closed position.
Take note of the “parachute” folding method used to fold the canopy when closed.
See TO PROPERLY FOLD THE SIRIUS CANOPY section for more details.
2. Make sure your slider car stop pin is in the ready or horizontal position.
3. Begin turning the winder clockwise until the slider car stop pin auto locates into the lowest predetermined hole. Continue winding until the canopy is taut. The canopy will now be in Tilt position 1.

CAUTION: NEVER FORCE THE ARMS OPEN IF YOU FEEL RESISTANCE IN THE WINDER!

If you feel resistance in the winder, you should manually pull out a few arms to help facilitate winding. Once the canopy is open, look up into the arms to confirm that all spacer buttons are inserted. You should be able to locate small white plastic circular “buttons”, one in each of the arms. If you do not see all eight spacer buttons in place, contact dealer immediately. Until you have received new spacer buttons and have all eight installed, continue to manually pull out a few arms with each opening to facilitate winding open the canopy. The Sirius warranty does not cover repairs resulting from not having eight spacer buttons inserted at all times.

OPEN TO THE SECOND POSITION

1. Open the winder handle and turn counter-clockwise for a few revolutions to release the pressure.
2. With your slider car stop pin again in the ready or horizontal position, quickly pull out the pin (making sure it stays in the horizontal position), and let it slide up the slider car on its own until the pin auto locates in the next predetermined hole. It may be necessary to turn the winder a few times until the pin auto locates. Once the pin is located in the hole, continue winding until the canopy is taut. The canopy will now be in Tilt position 2.

OPEN TO THE THIRD POSITION

1. Repeat steps 1-3 outlined above.
2. The canopy will now be in the Horizontal position.

HELPFUL HINT: At any time, you may skip a position and open to the desired position by turning the slider car stop pin parallel with the mast. In this position, the pin will NOT auto locate as it passes over the predetermined holes. If you choose to pass the tilt position(s) and go directly to the horizontal canopy position, you may move the pin into the parallel position and continue winding, but be sure to turn the pin back to the horizontal position before the horizontal canopy position is attained. If you pass the top hole, take the tension out of the canopy and then pull the slider car stop pin down and into the top hole.

TO ROTATE THE SIRIUS LATERALLY THROUGH 360°/ 10 POSITIONS

There are 10 holes at the top of the internal stem.

1. Raise the turning handle and rotate mast to a new position.



TO LOWER THE SIRIUS CANOPY

1. Open winder handle and turn crank handle counter-clockwise for several revolutions until all pressure is released.
2. Reach up and pull slider car stop pin out of hole. Continue to turn counter clockwise to close. If slider locks, pull out.
3. Strap the canopy to the mast with the strap.

TO PROPERLY FOLD THE SIRIUS CANOPY

The 100% solution dyed canopy will last longer if you fold it as it was packed and shipped. This technique is similar to the way a parachute is folded and is especially important when folding the Sirius canopy for seasonal storage or when the Sirius is to be left in the closed position for an extended period of time.

Using this technique at all times will significantly extend the life of the canopy.

1. When the canopy has been fully lowered, stand in front of the canopy structure and begin the folding process by pulling out two panels opposite the mast. Pull the two panels together and roll tight into the canopy.
2. Once rolled tight, pull adjacent panels out one at a time and fold to the center, alternating sides until all the panels have been pulled out from the arms and folded into the center.
3. Strap the canopy to the mast with the strap.

PROTECTIVE COVER

1. Screw rods together and insert into slit of the cover.
2. Unzip cover.
3. Using the rod as a guide, slide cover over your umbrella.
4. Pull on string to zip down your cover and tie.

LIGHT ADAPTER

Open Light Adapter

Loosen light adapter built into the umbrella runner by turning counter-clockwise. After loosening, pull down light adapter post and attach umbrella light (sold separately).

Close Light Adapter

Gently push up the light adapter post back into umbrella runner and tighten turning clockwise **NOTE:** It is not necessary to remove light to close umbrella.

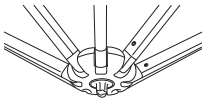

Light Adapter

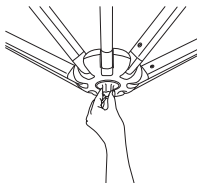

Turn counter-clockwise to open

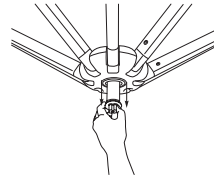

Pull down to open

MAINTAINING THE SIRIUS FRAME & FITTINGS

1. Hose mast and frame with water periodically, more often if installation is in a salty or industrial environment.
2. Inspect the installation fitting on a regular basis and tighten if necessary.
3. Lubricate the track and slider car mechanism as needed to enhance the ease of operation.

MAINTAINING THE SIRIUS CANOPY FABRIC

1. Clean up spills and stains right away. Spills can be removed by using a clean, absorbent cloth.
2. For general maintenance, use a soft brush to remove dust and dry soil or wash down with clean, warm water (i.e. garden hose) every so often so dirt does not become engrained. Allow the fabric to dry naturally before closing the canopy.
3. If a thorough cleaning is necessary, sponge over the fabric using a mild soap solution (2% solution). Rinse well with plenty of water to remove all soap residue.
4. Never use detergents, cleaning fluids, or solvents. Grease and oil stains may be removed by using turpentine or similar with an absorbent cloth.
5. We recommend giving the canopy a good clean on a more frequent basis if installed in a location where the canopy is likely to become soiled.

REMOVAL & REPLACEMENT OF THE SIRIUS CANOPY

Follow these instructions should you choose to replace your canopy with a new canopy.

1. Lower the canopy to the closed position.
2. Take out the canopy screws from webbing at top of arms. (Depending on your model, your SIRIUS will have rivets or screws, not both.)
3. Remove the button/screw at the end of each arm.
4. Separate the Velcro strap along the main canopy arm and remove the canopy from the structure.
5. To replace the canopy, reverse the above process.

OTHER SHADEMAKER STYLES AVAILABLE

Side Posts



Orion



Galaxy

Center Posts



Astral



Corona

Top Mount



Nova

shademaker

13401 Brooks Drive
Baldwin Park, CA 91706
p 626.338.8810
f 626.338.8816
info@shademakerusa.com

shademakerusa.com